



Forward Thinking. High Achieving.

BIG SKY HIGH SCHOOL

Our proposal addresses areas of critical need, including updating technology infrastructure, increasing safety and security, addressing deferred maintenance and improving flexible learning spaces.



A systemwide initiative to develop schools that work smarter for our students.

MEET YOUR SMART SCHOOLS TEAM

The Big Sky High School team put months into this process. We appreciate the input from students, parents, faculty, neighbors and the MCPS board. If you have questions or would like to get involved, we encourage you to visit www.mcpsmt.org/bigsky or contact Principal Natalie Jaeger at ncjaeger@mcps.k12.mt.us.

TEAM MEMBER CORE

Bethany Shepard, Teacher
Marta Pierpoint, Parent
Nikolay Andrushevich, Student
Wendy Gay, Classified
Brian Fortmann, Administrator

TEAM MEMBER EXPANDED

Dylan Dwyer, Teacher
Michelle Manning, Classified
Jennifer Courtney, Administrator
Kathleen Kennedy, Teacher
Matt Johnson, Teacher
Rhonda Wakai, Parent
Sarah DeGrandpre, Teacher

21ST CENTURY NEEDS

Big Sky High School, opened in 1980, is a beautiful facility for teaching and learning but lacks a clearly defined entrance, which raises safety and security concerns. Current technology infrastructure is not sufficient for mobile learning, and many learning spaces need renovation in order to maximize their use by students and teachers. In addition, the building roof suffers serious deferred maintenance.

EXPANDING BIG SKY HIGH SCHOOL

Our proposal to improve the building is designed to ensure Big Sky High School students have a facility that meets the educational needs of 21st-century high school students. When complete, Big Sky will be a smarter school in many ways, including:

- An entryway that is visible to students, staff and parents — ensuring the safety and security of our building.
- A wireless Internet infrastructure that allows students to access online learning and create digital products from any educational space within the building.
- An increase in flexible learning spaces — supporting students and staff working in teams, collaborating and problem-solving.
- A repaired roof — preventing further leakage into classrooms and disruptions to classes.



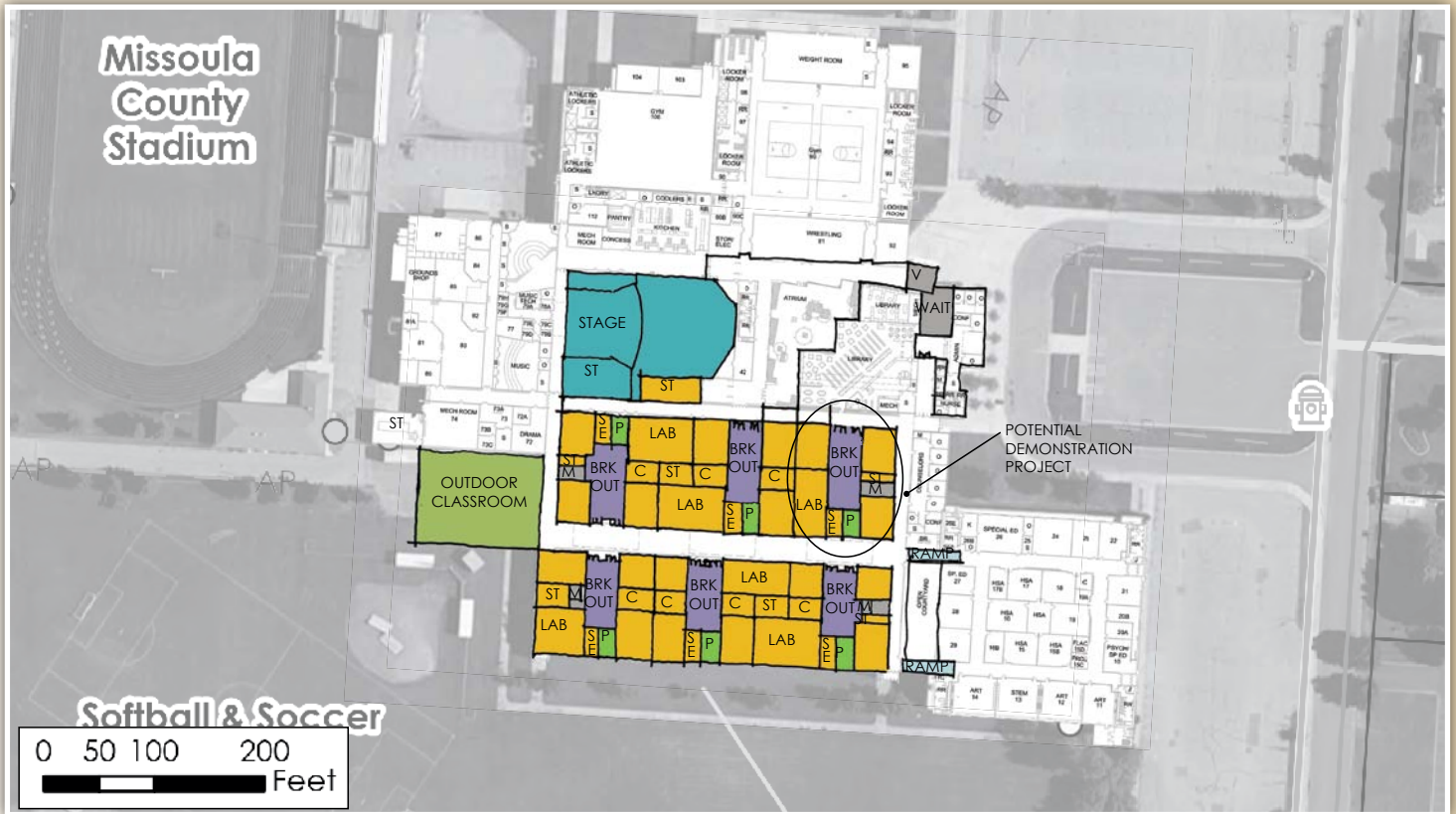

OUR TEAM'S RECOMMENDED OPTION



OPTION E-1 EXPAND:

- Secure entry and waiting area.
- Enclose courtyard for dining/commons.
- Convert cafeteria into performance space.
- Expand stage.
- Create small learning communities within core classroom areas.
- Extend library roof over atrium with north- and south-facing windows.
- Address deferred maintenance and energy conservation projects.

SECURITY

Modify facility to create obvious main entry, secure waiting area and ability to observe visitors approaching the building. Subdivide the building into secure zones with electronically activated door closers.

TECHNOLOGY

Develop high-speed/high-volume fiber optic distribution to breakout spaces for projects, presentations and technology in each learning community, enhanced with robust wireless and hard-wired access points.

ENVIRONMENT

Install barn doors and garage doors with quality acoustical materials between learning areas and breakout areas for projects, presentations and technology. Create small learning communities for teams of teachers and students that include traditional classrooms as well as important support spaces for 1:1 tutoring, small groups, planning centers, storage, etc.

FACILITIES STRATEGIC PLAN

Site Area: 35.98 acres
 Parking spaces: 600
 Building Square Footage
 Existing: 255,873
 Renovate: 58,300
 New: 6,000
 Total Project Cost: \$13,731,795
 Replacement Cost: \$62,160,000
 Remaining Deferred Maintenance & Energy Project Costs: \$0
 Rental / Lease / Sale Income: None
 Current Enrollment: 1,083
 Future Peak Enrollment: 1,332
 Capacity: 1,500–1,800

Costs include construction, demolition (where applicable), technology, furnishings, site development, design fees, and acquisition (where applicable). Contingency and escalation to January 2020.



NOW IS THE TIME TO INVEST IN SMARTER SCHOOLS

Education has never been more important than it is today. Our students face international competition for scholarships and jobs, and an increasing pace of change that impacts their futures. Yet, while the need for quality education continues to increase, our schools are physically in decline.

At Missoula County Public Schools, we realize that we must change if we're to keep up academically and economically as a community. That's why we launched Smart Schools 2020. Led by teams from each school, the initiative assesses needs by facility and prioritizes those needs in light of achieving our goals of a 21st Century Educational Culture and of being fiscally responsible.

By addressing schools now we prevent further deterioration of facilities, better prepare for population growth and ensure our students continue to get the educational opportunities they need to succeed in school and beyond.

THE SMART SCHOOLS PROCESS

SCHOOL CENTRIC:

Criteria and preferred options were established for each school by a team of teachers, administrators, students and parents from that school, along with members of the Missoula community.

COLLABORATIVE:

Alternatives were shared at public meetings at each school. In addition, surveys were sent out systemwide to vet priorities.

REALISTIC:

Team recommendations will be reviewed by the steering committee and the elected board of trustees before a bond measure is drafted.

PUBLIC:

Everyone is invited to review options and weigh in. Final support for the initiative will be determined by public election in November 2015.



To get involved, please visit www.mcpsmt.org/bigsky or contact Principal Natalie Jaeger at ncjaeger@mcps.k12.mt.us.